

YIZUMI Online Open Week 2020

伊之密 2020云开放周

连接中欧 智慧未来

展机方案介绍

Exhibition Machine
Solution Introduction

免责声明 Disclaimer:

1. 页面所有数据均来源于伊之密工厂，请以实际定制设备情况为准；
2. 页面中的产品图片及文字内容仅作参考，实物产品效果（包括但不限于外观、颜色、尺寸）可能略有差异，请以实物为准；

1. All data on the page comes from YIZUMI factory, please refer to the actual customized equipment;
2. The product pictures and text content inside are for illustrative purposes only, the actual product performances (including but not limited to appearance, color, and size) may be slightly different, please refer to the actual product;

ReactPro 聚氨酯与注塑一体化成型方案

Polyurethane and Injection Molding Integrated Solution



UN500DP两板式注塑机
UN500DP Two-platen Injection Molding Machine



SpaceA工业3D打印机
SpaceA Industrial Pellet
3D Printing

方案简介 / Introduction

UN500DP两板式注塑机集成PUR设备，并搭载InPUR“1+2”创新模具技术和自动化系统，实现“一步成型”ReactPro聚氨酯与注塑一体化成型工艺，高效生产软触感表面的汽车发动机盖。同时协同伊之密SpaceA 柔性增材制造系统，实现规模化注塑成型与个性化定制的结合生产。

YIZUMI's UN500DP two-platen injection molding machine equipped with PUR system, InPUR "1+2" innovative mold technology and automation system, which can realize "one-step" ReactPro polyurethane in-mold coating injection molding process and produce automotive engine cover with soft touch surface. By accommodating the SpaceA flexible additive manufacturing system, the solution can achieve the combination of large-scale injection molding manufacturing and customization.

重点推介 / Highlights

- 一步成型“注塑+聚氨酯”双物料，周期短，效率高，成本低；
- 一机多能，一套设备适合高光、耐刮擦、自愈合、软触感等不同效果的聚氨酯材料成型，灵活、智能、高效；
- 注塑+3D打印，规模生产与个性定制的高效混合生产。
- One-step molding 'injection+ polyurethane' with short cycle time, high efficiency and low cost;
- Multi-functional machine, suitable for polyurethane molding of high-gloss, corrosion resistance, scratch resistance, self-repair, soft touch and other effects. Flexible, intelligent and efficient;
- Injection+3D printing, achieving combination of large-scale injection molding manufacturing and customization.



展示案例介绍 / Application Example

产品名称：汽车发动机盖
成型模具：InPUR“1+2”创新模具
材料：AKROMID® RM-D GF20 + SHGPuR
产品尺寸(L x W x H)：400 × 350 × 25 mm
重量：475g
成型周期：70s

Part: Engine Cover
Molds: InPUR "1+2" innovative molds
Material: AKROMID® RM-D GF20 + SHGPuR
Part size (L x W x H): 400 × 350 × 25 mm
Part weight: 475 g
Cycle time: 70s



扫描二维码
观看视频



Scanning QR Code
to Watch Video

合作伙伴 / Partner



* 1. 页面所有数据均来源于伊之密工厂，请以实际定制设备情况为准；
2. 以上页面中的产品图片及文字内容仅作参考，实物产品效果（包括但不限于外观、颜色、尺寸）可能略有差异，请以实物为准；

FoamPro 微发泡注塑成型方案

Microcellular Foaming Injection Molding Solution



UN1500DP两板式注塑机
UN1500DP Two-platen Injection Molding Machine

方案简介 / Introduction

UN1500DP两板式注塑机以出色的SmartClamp智能锁模系统，搭载航空级铝合金模具技术、陶瓷涂层技术和FLEXflow伺服针阀流道系统，实现基于MuCell技术深度开发的FoamPro微发泡注塑。

The UN1500DP two-platen injection molding machine which is equipped with the high-performance SmartClamp system, aircraft aluminum mold technology, alternative temperature technology, Ceramic Coating technology and FLEXflow servo-driven hot runner system is able to perform FoamPro microcellular foam injection molding process developed based on MuCell technology.

重点推介 / Highlights

- 实现轻量化：减重达20%，成型周期缩短达30%，锁模力降低达50%；
- 四大“黑科技”：SmartClamp智能锁模系统、航空级铝合金模具技术、FLEXflow伺服针阀热流道系统、陶瓷涂层技术；
- 最佳表面效果：有效消除翘曲、缩水，同一产品获得皮纹、颗粒、高光、哑光四种表面效果；
- Achieve lightweighting: weight reduction up to 20%, cycle time reduction up to 30%, clamping force reduction up to 50%;
- Four cutting-edge technologies: Smart Clamp system, aircraft aluminum mold technology, Ceramic Coating technology and FLEXflow servo-driven hot runner system;
- Optimum surface effect: eliminate sink marks and warpage, four textures on same part surface- leather, particle, high-gloss, dull polish.



展示案例介绍 / Application Example

产品名称：微发泡公文箱

成型腔数：一出一

材料：Wancom PPT2304N C2

尺寸(L x W x H): 570 × 400 × 40 mm

重量：880g

成型周期：49s

Part: Foamed Briefcase

Number of cavities: 1

Material: Wancom PPT2304N C2

Part size (L x W x H): 570 × 400 × 40 mm

Part weight: 880g

Cycle time: 49s



扫描二维码
观看视频



Scanning QR Code
to Watch Video

合作伙伴 / Partner



* 1. 页面所有数据均来源于伊之密工厂，请以实际定制设备情况为准；
2. 以上页面中的产品图片及文字内容仅供参考，实物产品效果（包括但不限于外观、颜色、尺寸）可能略有差异，请以实物为准；

DirectPro-DIM 长纤维直接注射成型方案

Long Fiber Direct Injection Molding



UN1000DP两板式注塑机
UN1000DP Two-platen Injection Molding Machine

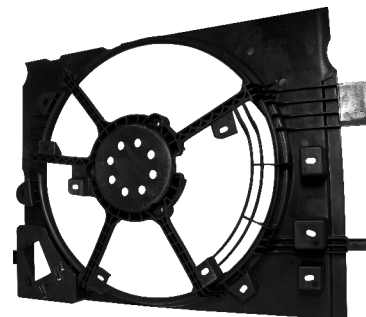

方案简介 / Introduction

UN1000DP两板式注塑机搭载纤维剪切计量喂料装置，实现长纤维直接注射成型工艺，纤维低折损率，产品高强度，可替代纤维增强工程塑料，降低原料成本。

UN1000DP two-platen injection molding machine is equipped with continuous fiber shearing metering feeding device to realize long fiber direct injection molding process (DIM), low fiber breakage rate and high strength. It can replace fiber-reinforced engineering plastics and reduce raw material cost.

重点推介 / Highlights

- 纤维折损率极大降低,较长纤粒料最终产品玻纤长度提升50%;
- 产品力学性能增强、强度提高,替代长纤粒料,可降低30%-50%原料成本;
- 根据不同产品要求,个性化选择纤维长度,纤维比例和材料组合。
- The fiber breakage rate is greatly reduced which the final product fiber length is improved by 50% compared to that of long fiber granulate.
- The product has enhanced mechanical properties and improved strength, which can replace engineering plastics and reduce production costs by 30% -50%.
- The fiber length, fiber percentage and material combination can be adjusted independently according to the product requirements.

展示案例介绍 / Application Example

产品名称: 汽车风扇框

成型腔数: 一出一

材料: PP(Sabic 513MNK40T) 玻纤 (CPIC ER4305PM-2400)

尺寸(L x W x H): 540 × 425 × 85mm

重量: 750g

成型周期: 70s

Part: Fan Frame

Number of cavities: 1

Material: PP(Sabic 513MNK40T) Glass fibre (CPIC ER4305PM-2400)

Part size(L×W×H): 540 × 425 × 85mm

Part weight: 750g

Cycle time: 70s



扫描二维码
观看视频



Scanning QR Code
to Watch Video

合作伙伴 / Partner



* 1. 页面所有数据均来源于伊之密工厂, 请以实际定制设备情况为准;
2. 以上页面中的产品图片及文字内容仅供参考, 实物产品效果 (包括但不限于外观、颜色、尺寸) 可能略有差异, 请以实物为准;

SpaceA 增材制造成型方案

Additive Manufacturing Molding Solution



SpaceA工业3D打印机
SpaceA Industrial Pellet 3D Printing

方案简介 / Introduction

SpaceA工业3D打印机由伊之密螺杆式挤出系统，机器人轨迹控制技术及模块化打印平台组成，精准高效达成中大物件低成本快速增材制造任务，实现小规模生产制造功能。

SpaceA industrial pellet 3d printing is based on the YIZUMI screw extruder system, robot posing control system and modular print platform. The low-cost and fast additive manufacturing task in medium and large objects with precision and high efficiency can be achieved and the small-scale production manufacturing also can be realized.

重点推介 / Highlights

- 高效：螺杆最大挤出量约1.2kg/h，生产效率较传统的FDM提高约28倍；
- 强度：选择纤维增强材料，制品强度更高，尺寸更稳定；
- 成本：颗粒原材料成本相比传统的FDM下降约80%。
- High efficiency: the maximum screw extrusion capacity is about 1.2kg/h, the production efficiency can be improved around 28 times than that of the traditional FDM technology;
- Intensity: higher product intensity and more stable dimension with the selection of fibre-reinforced materials;
- Cost: the cost of the granular raw material is dropped around 80% than that of the traditional FDM technology



展示案例介绍 / Application Example

产品名称：自行车车架

材料：Akro B31CF30

尺寸(L x W x H): 620 × 150 × 200 mm

填充：30%CF填充

重量：700g

成型周期：100mins

Part: Bicycle Frame

Material: Akro B31CF30

Part size(L×W×H): 620 × 150 × 200mm

Fillings: 30%CF

Part weight: 700g

Cycle time: 100mins



扫描二维码
观看视频



Scanning QR Code
to Watch Video

合作伙伴 / Partner



* 1. 页面所有数据均来源于伊之密工厂，请以实际定制设备情况为准；
2. 以上页面中的产品图片及文字内容仅供参考，实物产品效果（包括但不限于外观、颜色、尺寸）可能略有差异，请以实物为准；

保险杠成型自动化方案

Bumper Molding Automation Solution



UN3200DP两板式注塑机
UN3200DP Two-platen Injection Molding Machine

方案简介 / Introduction

以UN3200DP系列两板式注塑机为基础，搭配换模平台、机器人取件、割料头、烧边、称重系统等一系列辅机自动化设备，达到汽车保险杠自动化生产的目的，并能快速更换产品。

With the UN3200DP machine as the base and a series of auxiliary automatic equipment such as mold-changing platform, robot-pickup, cropping, open flame deflashing, weighing, etc. to achieve bumper molding automatic production and quick replacement of products.

重点推介 / Highlights

- 高效：自动换模，快速实现产品更换，配合自动化系统快速取件并完成割料头和烧边动作；
- 精密：制品重复精度<3‰；
- 节能：达到国家一级能耗水平。
- High efficiency: switch mold automatically and realize quick replacement of products
- High precision: product weight repeatability<3 ‰;
- Energy-saving: reach the national Grade 1 energy consumption.



展示案例介绍 / Application Example

产品名称：汽车保险杠

成型腔数：一出一

材料：PP+EPDM-TD20

尺寸(L x W x H): 1850 × 380 × 560 mm

重量：2000g

成型周期：50s

Part: Bumper

Number of cavities: 1

Material: PP+EPDM-TD20

Part size(L×W×H): 1850 × 380 × 560 mm

Part weight: 2000g

Cycle time: 50s



扫描二维码
观看视频

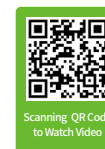

Scanning QR Code
to Watch Video

合作伙伴 / Partner



* 1. 页面所有数据均来源于伊之密工厂，请以实际定制设备情况为准；
2. 以上页面中的产品图片及文字内容仅作参考，实物产品效果（包括但不限于外观、颜色、尺寸）可能略有差异，请以实物为准；

汽车保险杠注塑成型方案

Bumper Injection Molding Solution



UN4000DP两板式注塑机
UN4000DP Two-platen Injection Molding Machine

方案简介 / Introduction

UN4000DP有精密稳定、高效节能、可应用特殊工艺三大性能优势。此方案展示的是UN4000DP生产汽车保险杠，机器的开模终点位置精度达到±0.2mm，为自动取件提供可靠条件。除了汽配行业，机器还可应用于物流、建材、环保行业，能够满足相关产品所需要的工艺条件。

The performance advantages of the UN4000DP are precision and stability, energy efficiency, special process application. The accuracy for the mold opening position can reach ±0.2mm which provide a reliable condition for automatic part pick-up in the solution of UN4000DP bumper injection molding production. In addition to auto parts industry, the machine can also be used in logistics, building materials, environmental protection industries, to meet the requirements of the process conditions in relevant products.

重点推介 / Highlights

- 开模终点位置精度达到±0.2mm，制品重量重复精度≤3%；
- 模板与导柱零接触，动作更快，干循环时间11s，提升生产效率22%；
- 动力系统采用高性能Ecoservo伺服驱动和柱塞变量泵组合，动力足，响应快，能耗达到国家一级要求；
- 基于模块化技术设计以及优异的硬件结构，机器可配置多种特殊工艺技术解决方案。
- The accuracy for the mold opening position can reach ±0.2mm and the deviation of product weight ≤3%；
- Non-contact between platens and tie bars, faster response. The dry cycle is only 11s, it can improve 22% of the production efficiency；
- By adopting high-performance servo driver combined with a piston variable pump, the driving system offers adequate power and rapid response which also meet the requirements of the national Grade 1 energy efficiency；
- Through customized design and outstanding hardware, the machine can integrate a variety of special applications.



展示案例介绍 / Application Example

产品名称：汽车保险杠

成型腔数：一出一

材料：PP+EPDM-T20

尺寸(L×W×H)：1740×480×240 mm

重量：1.8 kg

成型周期：45s

Part: Bumper

Number of cavities: 1

Part size(L×W×H): 1740×480×240 mm

Material: PP+EPDM-T20

Part weight: 1.8 kg

Cycle time: 45s



扫描二维码
观看视频



Scanning QR Code
to Watch Video

合作伙伴 / Partner



* 1. 页面所有数据均来源于伊之密工厂，请以实际定制设备情况为准；
2. 以上页面中的产品图片及文字内容仅供参考，实物产品效果（包括但不限于外观、颜色、尺寸）可能略有差异，请以实物为准；

IMDPro 模内装饰成型方案

In-mold Decorative Molding Solution



FF系列电动注塑机
FF Series Electric Injection Molding Machine

方案简介 / Introduction

全维度升级的FF系列电动注塑机，在保留原有的SDC伺服直控技术基础上，融合最新研发成果：SmartClamp智能锁模系统，精密的二次合模控制技术结合低压注射功能，搭载具备压缩结构的先进模具控制技术、IMD模内装饰技术，展示5G手机背板的系统解决方案。

The all-dimensions upgraded FF series electric injection molding machine is equipped with the latest R&D achievement while keeping the original Servo Direct Control technology. SmartClamp intelligent system, the precision two-stage mold opening and closing technology combined with low-pressure injection function, carrying with advanced mold control technology with compression structure, IMD in-mold decorative technology, displaying 5G mobile phone back frame solutions.

重点推介 / Highlights

- SmartClamp智能锁模系统，精密的二次合模控制技术结合低压注射功能，搭载具备压缩结构的先进模具控制技术、IMD模内装饰技术；
- 更精密：全维度升级的FF系列电动注塑机，制品重复精度0.1%；
- 展示5G手机背板的系统解决方案；
- SmartClamp intelligent system, the precision two-stage mold opening and closing technology combined with low pressure injection function, carrying with advanced mold control technology with compression structure, IMD in-mold decorative technology;
- Precision: All-dimensions upgraded FF series electric injection molding machine, product repeatability 0.1%;
- Displaying 5G mobile phone back frame solutions.



展示案例介绍 / Application Example

产品名称：手机壳背板

成型腔数：一出一

材料：PC

尺寸(L x W): 158×78 mm

重量：17.7g

壁厚：0.7mm

成型周期：25s

Part: Mobile Phone Back Frame

Number of cavities: 1

Material: PC

Part size(L×W): 158×78 mm

Part weight: 17.7g

Wall thickness: 0.7mm

Cycle time: 25s



扫描二维码
观看视频



Scanning QR Code
to Watch Video

合作伙伴 / Partner

NIESHA

* 1. 页面所有数据均来源于伊之密工厂，请以实际定制设备情况为准；
2. 以上页面中的产品图片及文字内容仅供参考，实物产品效果（包括但不限于外观、颜色、尺寸）可能略有差异，请以实物为准；

PacPro 薄壁包装产品成型方案

Thin-walled Packaging Product Molding Solution



PAC420KP高速注塑机 配 4+4叠层模具
PAC420KP High-speed Injection Molding Machine with 4+4 Stack Mold

方案简介 / Introduction

PacPro方案适合薄壁包装类容器产品的高速注射成型，具有高效、稳定的成熟技术，并为客户量身定制一站式解决方案，提供机器、模具、辅机和售后服务在内的高品质注塑方案和交钥匙工程服务，满足客户未来多样化的生产需求。

The PacPro solution is suitable for high-speed injection molding of thin-walled packaging products with stable, efficient and mature technology, tailored to the needs of the customers with a one-stop solution, delivering high-quality injection molding solutions, including machines, molds, auxiliary equipment, after-sales services and turnkey projects to meet the diversified production needs of the customers in the future.

重点推介 / Highlights

- 高效：干周期达2.7秒，生产效率提高75~85%；
- 节能：产品能耗更低，提高生产效益；
- 搭配最新PAC420KP新机型，性能提升；
- High efficiency: 2.7s dry cycle time, production efficiency is increased by 75~85%;
- Energy-saving: lower energy consumption and higher production efficiency;
- Equipped with the newly PAC420KP machine with improved performance;



展示案例介绍 / Application Example

产品名称：医疗耗材圆碗

成型腔数：4+4

材料：pp (FPC70T)

产品容积：1000ml

重量：26g

成型周期：7.5s

Part: Medical Round Bowl

Number of cavities: 4+4

Part volume: 1000ml

Part weight: 26g

Cycle time: 7.5s



扫描二维码
观看视频



Scanning QR Code
to Watch Video

合作伙伴 / Partner

SWITEK®
思为睿

Milliken

سابك
sabic

* 1. 页面所有数据均来源于伊之密工厂，请以实际定制设备情况为准；
2. 以上页面中的产品图片及文字内容仅供参考，实物产品效果（包括但不限于外观、颜色、尺寸）可能略有差异，请以实物为准；

MultiPro 多物料对射成型方案

Multi-component Injection Molding Solution



UN900DP MultiPro-HM水平转盘对射双色机
UN900DP MultiPro-HM Horizontal Rotary Table
Two-color Injection Molding Machine

方案简介 / Introduction

UN900DP MultiPro-HM水平转盘对射双色机搭配水平转盘和中板，采用对射结构。动板、中板开合模终点重复精度高，模具兼容性更大，相较其它多物料方案，可以满足更大的模具外形尺寸。同等锁模吨位下，可满足更大型的双色制品，满足客户的特殊应用工艺需求。注射单元采用模组化设计可为客户提供多样化方案选择，且均采用高刚性射移支架配双层线性导轨设计，阻力低，为高注射精度提供了可靠保证。

UN900DP MultiPro-HM Horizontal Rotary Table Two-color Injection Molding Machine is equipped with horizontal rotary table and the middle platen and adopts correlation injection structure. Standard moving platen and middle platen mold-open/close endpoint repeat accuracy is high and the mold compatibility is greater, which is particularly suitable for injection molds with larger dimensions compared to other multi-component solutions. Under the same clamping tonnage, it can accommodate larger two-color products, meeting the requirements of special application processes. The modular design of the injection unit can provide customers with a variety of options, and all adopt a high rigid shooting bracket with double linear guide design, which is low-resistant and can provide a reliable guarantee for high injection accuracy.

重点推介 / Highlights

- 高效：动板、中板开模同步抽芯，对射射台成型周期短更短，配流系统均采用快换方式，提高工作效率；
- 功能：中板可实现高压开模功能，开模辅助力更大；采用配流轴+电滑环结构，在转盘360°旋转时可实现水、电、气、油同步传输；
- 精密：转盘采用伺服电机驱动，同时通过插销进行机械限位，保证旋转精度。

- High efficiency: Simultaneous core pulling can be realized with opening the mold on the movable platen and the middle platen, reducing the cycle time. The flow distribution system adopts fast-changing mode to improve work efficiency.
- Function: The middle platen can realize the function of high-pressure mold opening with higher mold opening auxiliary force; Equipped with automatic central rotary union technology + electric slip ring structure and the water, electricity and gas can be transmitted simultaneously when the turntable rotates 360 degrees.
- Precision: The turntable adopts a servo system, mechanical location limit can be attained with a bolt to ensure the accuracy of rotation;



展示案例介绍 / Application Example

产品名称：北汽汽车尾灯

成型腔数：一 出二

材料：PMMA 8N 00000 明白 & MMA 8N 33691 明红

尺寸(L×W×H): 570×400×40 mm

重量：99.5g

成型周期：60s

Part: BAIC Motor Taillight

Number of cavities: 2

Material: PMMA 8N 00000 bright white & MMA 8N 33691 bright red

Part size (L×W×H): 570×400×40 mm

Part weight: 99.5g

Cycle time: 60s



* 1. 页面所有数据均来源于伊之密工厂，请以实际定制设备情况为准；
2. 以上页面中的产品图片及文字内容仅作示意，实物产品效果（包括但不限于外观、颜色、尺寸）可能略有差异，请以实物为准；

FoamPro-Chem 化学微发泡注塑成型方案

Chemical Microcellular Foam Injection Molding Solution



UN1700DP两板式注塑机
UN1700DP Two-platen Injection Molding Machine

方案简介 / Introduction

UN1700DP两板式注塑机以出色的SmartClamp智能锁模系统，注射单元搭载了高速闭环伺服系统和专用的化学发泡塑化组件，采用LUVOBATCH注塑发泡专用的高性能环保发泡剂，搭载陶瓷涂层技术，实现基于化学发泡深度开发的FoamPro-Chem微发泡注塑技术。

UN1700DP two-platen injection molding machine has excellent SmartClamp system, the injection unit is equipped with the high-speed closed-loop servo system and special chemical foam injection units. Adopt the LUVOBATCH high-performance environmental protection foaming agent and apply with ceramic coating technology to achieve the FoamPro-Chem microcellular foam injection molding technology developed based on the in-depth developed chemical foaming.

重点推介 / Highlights

- 基于化学发泡深度开发的FoamPro-Chem微发泡注塑技术；
- 以出色的SmartClamp智能锁模系统，可以实现微发泡的coreback精密微开控制，并且带平行度自动修正控制，控制响应精度达到 $\pm 0.015\text{mm}/2\text{ms}$ ；
- 注射单元搭载了高速闭环伺服系统和专用的化学发泡塑化组件，可以实现高速、高精度的注射工艺；
- FoamPro-Chem microcellular foam injection molding technology developed based on the in-depth developed chemical foaming;
- It is able to realize coreback precisely tiny open technology on microfoaming with high-performance SmartClamp system. With automatic correction control of platen parallelism, the response accuracy can reach $\pm 0.015\text{mm}/2\text{ms}$;
- The injection unit is equipped with the high-speed closed-loop servo system and special chemical foam injection units, achieving high-speed, high-precision injection technology;



展示案例介绍 / Application Example

产品名称：微发泡汽车门板

成型腔数：一出一

材料：4050CT10 (PP/PE-T10)

发泡剂：LUVOBATCH PE BA 5821

尺寸(L×W×H)：800×700×100 mm

重量：1090g

成型周期：35s

Part: Foamed Automotive Door Panel

Number of cavities: 1

Material: 4050CT10 (PP/PE-T10)

Foaming agent : LUVOBATCH PE BA 5821

Part size (L×W×H): 800×700×100 mm

Part weight: 1090g

Cycle time: 35s



扫描二维码
观看视频



Scanning QR Code
to Watch Video

合作伙伴 / Partner



* 1. 页面所有数据均来源于伊之密工厂，请以实际定制设备情况为准；
2. 以上页面中的产品图片及文字内容仅供参考，实物产品效果（包括但不限于外观、颜色、尺寸）可能略有差异，请以实物为准；

Multipro 双色车灯罩成型方案

Two-color Taillight Cover Molding Solution



BTP系列多物料注塑机
BTP Series Multi-component Injection Molding Machine



方案简介 / Introduction

UN750C-BTP宽板高端多物料注塑机搭载“成型缺陷智能补偿技术”、伺服转盘精准定位技术和低速成型控制技术，为汽配领域车灯罩稳定成型和个性化定制提供一套性价比更优的选择方案。

YIZUMI 750C-BTP wide-platen high-end multi-component injection molding machine equipped with “smart compensation technology for molding defects”, precise positioning technology for servo turntable, low-speed control technology to provide a set of more cost-effective option for stable molding and customization of lights cover in the automotive industry.

重点推介 / Highlights

- 更高的稳定性：采用“成型缺陷智能补偿技术”成型稳定性更高，制品重量重复精度达1%；
- 更高的转盘控制精度：转盘动作快速平稳，定位重复精度±0.001度；
- 更优的中低速控制稳定性：系统可以在低于5%的速度下实现平稳注射，速度偏差不得超过5%，让低速成型制品获得更优的成型工艺；
- Higher stability: molding stability is improved by the “molding defect intelligent compensation technology”, and the product weight repeatability is up to 1%;
- Higher turntable control accuracy: the turntable action is fast and stable, and the positioning repeatability is ±0.001 degree;
- Better medium and low-speed control stability: the system achieves smooth injection at speeds below 5%, and the speed deviation is ≤5%, which enables the medium and low speed molded products to obtain a better molding process;

展示案例介绍 / Application Example

产品名称：汽车尾灯双色灯罩

成型腔数：2+2

材料：PMMA + PMMA

尺寸(L×W×H): 252 x 158 x 229mm

重量：82g

成型周期：50s

Part: Two-color Taillight Cover

Number of cavities: 2+2

Material: PMMA + PMMA

Part size (L×W×H): 252×158×229 mm

Part weight: 82g

Cycle time: 50s



扫描二维码
观看视频



Scanning QR Code
to Watch Video

* 1. 页面所有数据均来源于伊之密工厂，请以实际定制设备情况为准；
2. 以上页面中的产品图片及文字内容仅供参考，实物产品效果（包括但不限于外观、颜色、尺寸）可能略有差异，请以实物为准；

Multipro 三色隔热杯模内装配成型方案

Triple-color Insulated Water Cup In-mold Assembly Molding Solution



NSW系列驮式多物料注塑机
NSW Series Piggyback Multi-component Injection Molding Machine



方案简介 / Introduction

UN220C-NSW欧版驮式转轴多物料成型机搭载油电混合技术、伺服转轴精准定位技术、三色混合成型技术、模内装配技术、产品成型工艺追踪技术等，为多物料成型的提供更加复杂的解决方案。

UN220C-NSW European standard piggyback rotary shaft multi-component injection molding machine is equipped with hydraulic and electric hybrid structure, precise positioning technology for servo axis, triple-color combination molding technology, In-mold assembly technology, product molding process traceability technology, etc. which provides more complex solutions for multi-component molding.

重点推介 / Highlights

- 更高的稳定性：采用“成型缺陷智能补偿技术”成型稳定性更高，制品重量重复精度达1%；
- 更高的转盘控制精度：转盘动作快速平稳，定位重复精度 ± 0.001 度；
- 更优的中低速控制稳定性：系统可以在低于5%的速度下实现平稳注射，速度偏差不超过5%，让低速成型制品获得更优的成型工艺；
- Higher stability: molding stability is improved by the “molding defect intelligent compensation technology”, and the product weight repeatability is up to 1%;
- Higher turntable control accuracy: the turntable action is fast and stable, and the positioning repeatability is ± 0.001 degree;
- Better medium and low-speed control stability: the system achieves smooth injection at speeds below 5%, and the speed deviation is $\leq 5\%$, which enables the medium and low speed molded products to obtain a better molding process;

展示案例介绍 / Application Example

产品名称：三色隔热水杯
成型腔数：1+1
材料：PC + PC + PC
尺寸(H高×D杯口直径): 130×75 mm
重量：107.8g
成型周期：43s

Part: Triple-color Insulated Water Cup
Number of cavities: 1+1
Material: PC + PC + PC
Part size (Height×Diameter): 130×75 mm
Part weight: 107.8g
Cycle time: 43s



扫描二维码
观看视频



Scanning QR Code
to Watch Video

合作伙伴 / Partner



* 1. 页面所有数据均来源于伊之密工厂，请以实际定制设备情况为准；
2. 以上页面中的产品图片及文字内容仅作参考，实物产品效果（包括但不限于外观、颜色、尺寸）可能略有差异，请以实物为准；

水辅成型方案

Water-assisted Injection Molding Solution



UN500D1两板式注塑机
UN500D1 Two-platen Injection Molding Machine

方案简介 / Introduction

以UN500D1两板式注塑机为基础，搭配水辅机，实现无料包的水辅共注工艺，做到无原料浪费。

To achieve no waste of raw materials with the water-assisted co-injection process of non-material bag based on the UN500D1 two-platen injection molding machine with water-assisted machine.

重点推介 / Highlights

- 双色嵌入射出;
- 精密: 制品重复精度 $<3\text{‰}$;
- 溢料回流料管;
- Dual-color embedded injection;
- Precision: product repeatability $<3\text{‰}$;
- Flash refluxing material pipe;



展示案例介绍 / Application Example

产品名称: 轮子

成型腔数: 一出二

材料: PP、PP+50%GF

重量: 877g

Part: Wheel

Number of cavities: 2

Material: PP、PP+50%GF

Part weight: 877g



扫描二维码
观看视频



Scanning QR Code
to Watch Video

合作伙伴 / Partner



* 1. 页面所有数据均来源于伊之密工厂，请以实际定制设备情况为准；
2. 以上页面中的产品图片及文字内容仅作参考，实物产品效果（包括但不限于外观、颜色、尺寸）可能略有差异，请以实物为准；

Yi+ Platform 智能制造解决方案

Yi+ Platform Intelligent Manufacturing Solution



Yi+ Platform 伊之密智造平台
Yi+ Platform YIZUMI Intelligent Manufacturing Platform

方案简介 / Introduction

Yi+ 智造平台是面向高分子材料成型行业生产管理环节,应用物联网、云计算、大数据等新一代信息技术,解决客户生产过程中设备监控、效率统计、设备维修、故障处理、工艺参数监控和追溯等痛点问题,实现生产效率和制品品质提升。Yi+ 智造平台目前主要包括Yi MES (智造执行系统)和Yi CMS (状态监控系统)两个产品。

Yi+ intelligent manufacturing platform is used in the production process of the polymer material forming industry which integrates IoT, Cloud, Big Data and other new generation ICT technologies to solve the issues of equipment monitoring, efficiency statistics, equipment maintenance, troubleshooting, process parameter monitoring and traceability, etc., improving production efficiency and product quality. Yi+ intelligent manufacturing platform currently includes two products: Yi MES (manufacturing execution system) and Yi CMS (condition monitor system)



重点推介 / Highlights

Yi MES (智造执行系统 Intelligent Manufacturing Execution)

- 无需专职IT人员投入, 无需网络建设, 无需机房建设;
- 系统开放标准接口, 与主流ERP系统对接, 设备端支持主流品牌设备接入;
- 系统操作便捷, 简单易学, 快速上手;
- 3周快速上线, 让企业快速实现智能数字化生产;
- 金融级芯片数据加密, 网安二级等保认证, 保证客户数据安全;
- No need of full-time IT personnel, network construction and computer room construction;
- The system is open to the standard interface, connecting with the mainstream ERP system, and supporting the access of mainstream brand equipment at the device end;
- The system is easy to operate, easy to learn and easy to get started.
- 3 weeks to go, enabling enterprises to quickly realize intelligent digital production;
- Achieve financial-class of chip data encryption with second-level certification of network security to ensure the security of customer data;

Yi CMS (伊点通状态监控系统 Condition Monitor System)

- 一流效率: 设备状态实时监控, 异常停机及时推送, 降低停机损失;
- 一流品质: 工艺参数实时监控, 关键参数及时预警;
- 简单化一: 产量、效率、良率等生产报表一键生成, 简化管理;
- 一键掌控: 随时随地掌控车间生产状况。
- First-class efficiency: real-time monitoring of equipment status, timely announcement of abnormal shutdown to reduce machine shutdown loss;
- First-class quality: real-time monitoring of process parameters, timely warning of key parameters;
- Simplification: production report of output, efficiency, yield and so on can be achieved with one click which simplifies management;
- One-click control: production status of the workshop is at a glance anytime and anywhere.



* 1. 页面所有数据均来源于伊之密工厂, 请以实际定制设备情况为准;
2. 以上页面中的产品图片及文字内容仅供参考, 实物产品效果(包括但不限于外观、颜色、尺寸)可能略有差异, 请以实物为准;

